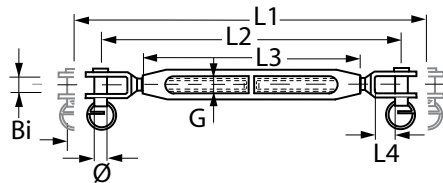
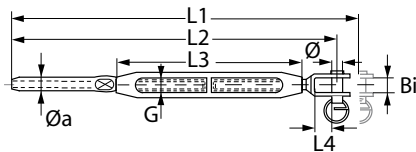

offene Hülse Bronze UNF, mit Gabeln aus Edelstahl 1.4401

 offene Bronzehülse, mit Gabeln aus Edelstahl 1.4401
 open body in bronze with fork / fork in AISI 316

Art.-Nr.	G UNF	L1 mm	L2 mm	L3 mm	L4 mm	Ø mm	Bi mm	BRL kg
PH130006A	1/4"	205	143	100	9,8	6,35	9,5	1300
PH130008A	5/16"	244	168	120	11,0	8,00	11,0	2200
PH130010A	3/8"	299	197	135	14,2	9,50	12,0	3400
PH130010A10	3/8"	278	202	135	15,9	9,50	10,0	3500
PH130011A	7/16"	312	222	150	17,5	11,00	12,0	4600
PH130012A	1/2"	358	248	170	18,5	12,70	14,0	6100
PH130016A16	5/8"	446	314	210	25,0	14,00	16,0	8000
PH130016AX	5/8"	450	312	210	25,0	16,00	18,0	9900
PH130020A	3/4"	562	392	250	38,5	19,00	24,0	14400

offene Hülse Bronze, UNF, mit Gabel / Terminal aus Edelstahl 1.4401

 offene Bronzehülse, mit Gabel / Terminal aus Edelstahl 1.4401
 open body in bronze with fork / terminal in AISI 316

Art.-Nr.	G UNF	L1 mm	L2 mm	L3 mm	L4 mm	Øa mm	Ø mm	Bi mm	Draht-seil	BRL kg
PH130306A	1/4"	236	174	100	8,2	6,35	6,35	9,5	3 mm	1300
PH130406A	1/4"	246	184	100	8,2	7,50	6,35	9,5	4 mm	1300
PH130408A	5/16"	280	204	120	11,0	7,50	8,00	11,0	4 mm	1700
PH130508A	5/16"	286	210	120	11,0	9,00	8,00	11,0	5 mm	2200
PH130510A	3/8"	317	233	135	14,2	9,00	9,50	12,0	5 mm	2400
PH130510A10	3/8"	317	233	135	14,2	9,00	9,50	10,0	5 mm	2400
PH130610A10	3/8"	328	252	135	16,0	12,58	9,50	10,0	6 mm	3500
PH130611A	7/16"	365	275	150	17,5	12,58	11,00	12,0	6 mm	4600
PH130711A	7/16"	370	280	150	17,5	14,20	11,00	12,0	7 mm	4600
PH130712A	1/2"	405	299	170	18,5	14,20	12,70	14,0	7 mm	6100
PH130816AX	5/8"	496	364	210	25,0	16,00	16,00	18,0	8 mm	8700
PH130816A16	5/8"	500	368	210	26,0	16,00	14,00	16,0	8 mm	8000
PH131016A	5/8"	509	375	210	25,0	17,80	14,00	18,0	10 mm	9700
PH131020A	3/4"	591	431	250	38,5	17,80	19,00	24,0	10 mm	9700
PH131220A	3/4"	606	446	250	38,5	20,00	19,00	24,0	12 mm	11400

offene Hülse Bronze, UNF, mit Walzterminal und Toggle aus Edelstahl

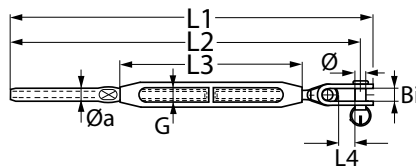
 offene Bronzehülse, mit Toggle und Walzterminal aus Edelstahl
 open body in bronze, with toggle and swage terminal in AISI 316

Art.-Nr.	G UNF	L1 mm	L2 mm	L3 mm	L4 mm	Øa mm	Ø mm	Bi mm	Draht-seil	BRL kg
PH330306A5G	1/4"	250	188	100	9,0	6,35	5,00	7,0	3 mm	1000
PH330306A	1/4"	255	193	100	13,8	6,35	6,35	8,0	3 mm	1300
PH330406A	1/4"	265	203	100	10,8	7,50	6,35	8,0	4 mm	1300
PH330406A6G	1/4"	269	207	100	10,8	7,50	6,35	10,0	4 mm	1400
PH330408A	5/16"	304	228	120	16,0	7,50	8,00	10,0	4 mm	1700
PH330508A	5/16"	310	234	120	16,0	9,00	8,00	10,0	5 mm	2200
PH330510A	3/8"	349	265	135	21,2	9,00	9,50	12,0	5 mm	2400
PH330610A	3/8"	364	280	135	21,2	12,58	9,50	12,0	6 mm	3400
PH330611AX	7/16"	397	307	150	22,5	14,20	11,00	15,0	6 mm	4600
PH330612AX	1/2"	425	319	170	28,5	12,58	12,70	18,0	6 mm	5400
PH330711AX	7/16"	408	318	150	22,5	14,20	11,00	15,0	7 mm	4600
PH330712AX	1/2"	433	327	170	28,5	14,20	12,70	18,0	7 mm	6100
PH330812AX	1/2"	448	342	170	28,5	16,00	12,70	18,0	8 mm	6100
PH330816AX	5/8"	536	404	210	33,0	16,00	16,00	20,0	8 mm	8700
PH33081612AX	5/8"	536	404	210	33,0	16,00	12,70	20,0	8 mm	6100
PH331016AX	5/8"	545	413	210	33,0	17,80	16,00	20,0	10 mm	9700
PH331020AX	3/4"	625	465	250	35,5	17,80	19,00	24,0	10 mm	9700
PH331220AX	3/4"	640	480	250	35,5	20,00	19,00	24,0	12 mm	11400
PH331222AX	7/8"	786	592	305	38,0	21,40	22,00	26,0	12 mm	14000

When working with swaging terminals the manufacturer and the working person have to make sure, that the diameters of wire rope, the diameters inside and outside of terminals and the size of used roller pair, are matching. Follow instructions of swaging machines manufacture exactly and check "Table of swage dimensions". All technical information without obligation, errors and production related variations with the usual tolerance range reserved!